



RIDGECREST APARTMENTS

Ridgecrest Apartments offers an affordable, subsidized living option for income-qualified adults 62 and over. These senior living apartments are federally subsidized and monthly rent is based on income, assets and medical expenses. Ridgecrest offers studio, one- and two-bedroom senior living apartments.



MONTHLY FEES INCLUDE:

- Utilities (Electricity, Gas, Water, and Trash)
- Free access to The Wellness Center
- Individualized wellness programs
- Emergency call systems in baths and bedrooms
- Resident services 24 hours a day
- The support that comes from being part of our community
- Complimentary transportation to shopping centers and recreational outings

RECREATIONAL FACILITIES

- Beautifully landscaped grounds & personal garden areas
- Outdoor recreational spaces
- Fishing in two lakes
- Regency Room for socializing, entertaining; can be reserved for private events
- Resident business center and WiFi access
- Exercise classes, yoga, bible study, movie night and potlucks
- Roanoke County Public Library, Glenvar Branch located adjacent to our campus
- Trout fishing and hiking at Green Hill Park minutes away

SERVICES AVAILABLE FOR AN ADDITIONAL CHARGE

- Telephone service
- Satellite television package
- Internet Service
- Beauty/Hair Salon service (in-house)
- Meal service options
- Transportation to physician appointments
- Personal housekeeping/companion services
- On-site pharmacy, physician offices, and dialysis center
- Access to a full continuum of health care services, at reduced rates, without leaving our campus

LEASE OPTIONS AVAILABLE

One (1) year lease with an automatic renewal clause, unless a thirty (30) day written notice to vacate is received. We collect a security deposit which is equal to one (1) month's rent. Small pets are allowed per the terms of our pet policy and agreement.



STUDIO APT | 434 SQ FT



1 BR, 1 BATH | 579 SQ FT



1 BR, 1 BATH | 605 SQ FT

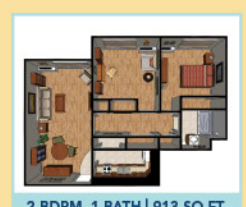

2 BDRM, 1 BATH | 913 SQ FT

PRICING

Income Qualifications

Rent is income based and cannot exceed 30% of adjusted income

Size of household

One person

Two persons

Three persons

Maximum income

\$40,950

\$46,800

\$52,650

**Fees subject to change*

Smoke free campus